



Fletcher[®] Insulation

Building Better, Together.



Residential Catalogue



Contents

Trusted solutions by Fletcher Insulation	3
Credentials	4
National Service Offer	5
NCC Deemed-to-Satisfy and FletcherSpec® Pro.....	6-7
Pink Batts®	8-9
Pink® Floor Batts	10
How many packs of Batts will I need?	11
Pink® Soundbreak®	12-13
Polyester Thermal Batts	14
Polyester Underfloor Batts	15
Polyester Acoustic Batts	16
Sisalboard® Expanded Polystyrene (EPS).....	17
PiRFORMATHERM® PIR Insulation.....	18
Fire Stop	
Party Wall Batts	19
Fire Seal	19
Fire Strip.....	19
Mass Loaded Vinyl Barrier	20
Pipe Acoustic Lagging	21
Permastop® Building Blanket	22-23
Pink® EmberGuard® Building Blanket	24
Sisalation® Tuff Wrap™	25
Permeable Membranes	26-27
Sisalation® VapaWrap™ Wall.....	26
Sisalation® VapaWrap™ Metal Roof.....	26
Tyvek® HomeWrap®	26
Dupont® Flashing Tape	27
Tyvek® Contractor Tape.....	27
Sisalation® Tile Roof	28
Sisalation® Metal Roof	29
Sisalation® Multipurpose	30
Sisalation® Foam Cell Resi Liner	31
Sisalation® Foam Cell Multipurpose.....	32
Tapes	
Thermatape™ Thermal Break Strip.....	33
Vapastop® 883 Reinforced Foil Tape.....	35
Plain Foil Tape	35
Product Application Guide	37



Trusted solutions: Fletcher Insulation

Fletcher[®]
Insulation

Building Better, Together.

With one of Australia's widest distribution and sales coverage networks, Fletcher Insulation provides energy efficient and acoustic solutions to the residential, commercial HVAC and industrial markets. We manufacture and distribute a wide range of insulation products specially designed for Australian thermal and acoustic systems.

At the forefront of innovation and development of new trends as well as cost effective and compliant products, we remain committed to offering valuable service to our customers. Our national sales force has the experience and knowledge to provide assistance for any project or development to meet non-combustibility, acoustic and energy efficiency performance requirements.

Residential, commercial and industrial building sectors demand products that enable buildings to meet stringent requirements as set out in the National Construction Code (NCC) for thermal, acoustic and fire performance. Our extensive product range ensures we are able to supply the most suitable product for any application.

The Residential Market

Insulation for residential homes, whether supplied during new construction or as a retro-fit, has been the cornerstone of our business for many years. The famous Pink Batts[®] brand is synonymous with quality home insulation and is used in ceiling, wall and sub-floor applications. Our thermal insulation products are available in a range of Material R-values to suit all Australian climate zones.

Consumer driven trends and modern designs have lead to an increased demand for acoustic insulation. This market is well catered for with Fletcher Insulation's Pink[®] Soundbreak[®] acoustic insulation range, which delivers acoustic performance equivalent to mineralwool.



Credentials

Fletcher Insulation strives to meet the highest level of every available national or international standard for its products and processes. We hold credentials granted by Good Environmental Choice Australia (GECA), Global Mark (for our Quality Management Systems), the National Construction Code (NCC), Safe Work Australia (formerly the Australian Safety and Compensation Council) and other national and global organisations.

Good Environmental Choice Australia (GECA)



Fletcher Insulation is Australia's first insulation company to be GECA certified for its glasswool batts and unfaced blanket range of products. This independent accreditation system recognises the development and manufacturing of products that have proven environmental performance and is recognised worldwide through its affiliations.

Products that are 'GECA Certified' automatically comply with the requirements under Emissions, Indoor Environment Quality, and Material Credits within all Green Star tools. GECA accreditation benefits consumers in knowing that their choice of Fletcher Insulation products for their insulation requirements will help reduce greenhouse gas emissions and reduce the impact on the environment during the product's entire life cycle.

CodeMark 30006/30007

Building products and systems displaying the CodeMark logo have building approval in all states and territories in Australia and in New Zealand. In Australia, certification is against the National Construction Code (NCC), and in New Zealand it is against the New Zealand Building Code (NZBC).

CodeMark reduces time and costs associated with seeking building approvals. Rather than seeking approval in individual states or territories – in Australia this might have meant up to eight individual applications – with CodeMark you only seek approval once. If approved, the product is accepted in all states and territories in Australia (NCC compliant) and in New Zealand (NZBC compliant). Fletcher Insulation Pink Batts® insulation (GM-CM30006 Rev B) and Permastop® Building Blanket with Roof Rack® (GM-CM30007 Rev. B) have been awarded CodeMark certification.



Global-Mark

Global-Mark ISO 9001 certification confirms our Quality Management Systems and instills confidence that Fletcher Insulation is a proven, compliant

company that adheres to the standards designed to provide a framework that will assist in identifying hazards/ issues/processes, quantify associated risks and implement control methods to eliminate, reduce or control these issues. Fletcher Insulation has received third party product certification to AS/NZS 4859.1 'Materials for the Thermal Insulation of Buildings' from Global-Mark for the majority of its glasswool insulation products used in residential and commercial buildings.



BSI Accreditation

Sisalation® Pliable Building Membrane products have attained BSI accreditation in accordance with ISO 9001 – Quality Management and AS/ NZS 4801 – Occupational Health and Safety Management Systems. This

specific accreditation provides assurance that Fletcher Insulation products are manufactured in accordance with international standards in addition to national OH&S regulations.



AS/NZS 4859.1 Compliant

Fletcher Insulation has received third party product certification to AS/NZS 4859.1. Materials for the thermal insulation of buildings from Global-Mark for most of the glasswool insulation products used in residential and commercial buildings.



FBS-1 Glasswool Bio-Soluble Insulation®

Fletcher Insulation glasswool products are manufactured from FBS-1 Glasswool Bio-Soluble Insulation®.

FBS-1 Glasswool Bio-Soluble Insulation® is safe to use and meets the criteria of Safe Work Australia to be classified as non-hazardous. Fletcher Insulation glasswool can be used with confidence in any residential, commercial or industrial application.

NCC Compliant

National Construction Code (NCC) requires that all insulation comply with the energy efficiency provisions outlined in AS/NZS4859.1. Other requirements for insulation products outlined in the NCC, depending on the application, include compliance with fire standards AS1530.1, AS1530.2, AS1530.3 or AS1530.4.



National Service Offer

Our Service Offer

- To best suit our customer's needs Fletcher Insulation offers:
 - Next working day delivery^{1,3} for stocked products, which is arranged on a first come, first serve basis. Order cut-off times³ apply.
 - Customer pick-up for stocked products can be arranged Monday to Friday (excluding public holidays). Prior arrangements and at least a one hour pick up notice must be made. Please check your local branch Service Offer for more details.
 - If customers require urgent delivery of stocked products, a courier can be arranged and will incur additional charges. This will be priced on request when the order is placed (branch metro and regional delivery times differ, please check your local branch Service Offer for more details)².
 - All deliveries are made on a first come, first serve basis until Fletcher Insulation transport facilities are exhausted (bookings are limited)¹. Fletcher Insulation will confirm ETA³ at time of order.
- Metro CTL³ blanket orders of less than 5000m² can be delivered within 2-5 working days following the receipt of the order (cut-off times apply). Delivery times for larger orders or regional deliveries will be agreed upon acceptance of order.
- All deliveries require a contact number at the delivery address for the Service Offer to apply.
- All store deliveries within the defined branch metro area³ under minimum order value³ will be charged the minimum delivery fee, unless otherwise stipulated. Please contact your sales representative for further details.
- All site deliveries within the defined branch metro area³ will be charged the minimum delivery fee, unless otherwise stipulated. All site deliveries outside of branch metro area³ will be priced on application, please contact your sales representative for further details.
- Deliveries with special requirements such as crane lifts or time-specific deliveries will incur additional charges priced on application.
- Building site deliveries require a letter of authority to drop in case there is no one available to accept the delivery.
- In regional³ areas² orders placed prior to the next working day delivery^{1,3} cut-off time³, can be delivered to the freight forwarder³ the next working day. From this point on the freight forwarder³ policy applies and freight charges are as agreed. (Delivery cut-off times vary between branches, please check your local branch Service Offer).
- In all delivery circumstances no liability is accepted in cases of force majeure³.
- Returns Policy:
 - A restocking fee of \$120 + GST³ or 20% of the total invoice value (whichever is higher) applies to all stock that is returned.
 - All returned goods must be in re-saleable condition as determined by Fletcher Insulation.
 - CTL³ and MTO³ products are non-refundable.

Conditions apply. Further details are provided in your local branch Service Offer.

¹ Next working day and same day delivery is not always possible as bookings are limited. Please note this offer is subject to stock availability.

² Metropolitan and Regional areas are as defined by branch.

³ Please see Definitions for explanation of terminology.

Definitions

Branch metro area: a geographical area defined by the branch.

CTL: Cut-To-Length: a special order where the length of a product is specified.

Cut-off time: time restriction on orders for delivery times as defined by the service offer.

ETA: Estimated Time of Arrival.

Force majeure: an event beyond the control of Fletcher Insulation (e.g. natural disaster).

Freight Forwarder: a carrying company that is contracted for the delivery of products on behalf of Fletcher Insulation.

GST: Goods and Services Tax.

Minimum order value: Single order value amount excluding GST as defined by the vendor.

MTO: Made-To-Order; product that is made for a specific order.

Next working day delivery: delivery prior to 4.00pm on the next working day from the date the order is placed.

Regional: area outside of metro area.

Same day delivery: delivered prior to 4.00pm on the day of order (charges apply).



NCC Deemed-to-Satisfy and FletcherSpec[®] Pro

NCC 2016 Deemed-to-Satisfy insulation requirements for residential class 1 and 10 buildings.

The following table outlines the insulation requirements under the Deemed-to-Satisfy provisions of the NCC for common residential roof systems. The minimum NCC insulation values recommended below can be used to meet the building performance requirements where the Deemed-to-Satisfy provisions as detailed in section 3.12 of the NCC are also met.

Table 1: Roofs and Ceilings

Table 1: Roofs and Ceilings								
Options	Minimum Total R-value for climate zones 1-8							
	1	2	3	4	5	6	7	8
i. A roof or ceiling with a roof upper surface solar absorptance value of not more than 0.4	5.1	5.1	5.1	5.1	5.1	5.1	5.1	6.3
ii. A roof or ceiling with a roof upper surface solar absorptance value of more than 0.4 but not more than 0.6	4.6	4.6	4.6	4.6	4.6	4.6	4.6	6.3
iii. A roof or ceiling with a roof upper surface solar absorptance value of more than 0.6	4.1	4.1	4.1	4.1	4.1	4.1	4.1	6.3

Concessions and variations apply. Refer to NCC 2016 Vol.2 Section 3.12.1.5

Table 2: External Walls

Table 2: External Walls								
Options	Minimum Total R-value for climate zones 1-8							
	1	2	3	4	5	6	7	8
i. An external wall that is part of an envelope	3.3	3.3	3.3	2.8	2.8	2.8	2.8	3.8
ii. An envelope wall other than an external wall	1.0	1.0	NIL	NIL	1.0	1.0	1.5	2.5
iii. For other than (ii)	2.3	2.3	2.3	1.8	1.8	1.8	2.8	3.8

Concessions and variations apply. Refer to NCC 2016 Vol.2 Section 3.12.1.5

Table 3: Floors

Table 3: Floors								
Options	Minimum Total R-value for climate zones 1-8							
	For the upward direction of heat flow			For the downwards direction of heat flow				
	1	2	3	4	5	6	7	8
i. A suspended floor without an in-slab heating or cooling system	1.5	1	1.5	2.25	1.0	2.25	2.75	3.25

Concessions and variations apply. Refer to NCC 2016 Vol.2 Section 3.12.1.5

For enclosed perimeter treatment, the underfloor airspace and its enclosure may be included in the Total R-value calculations.

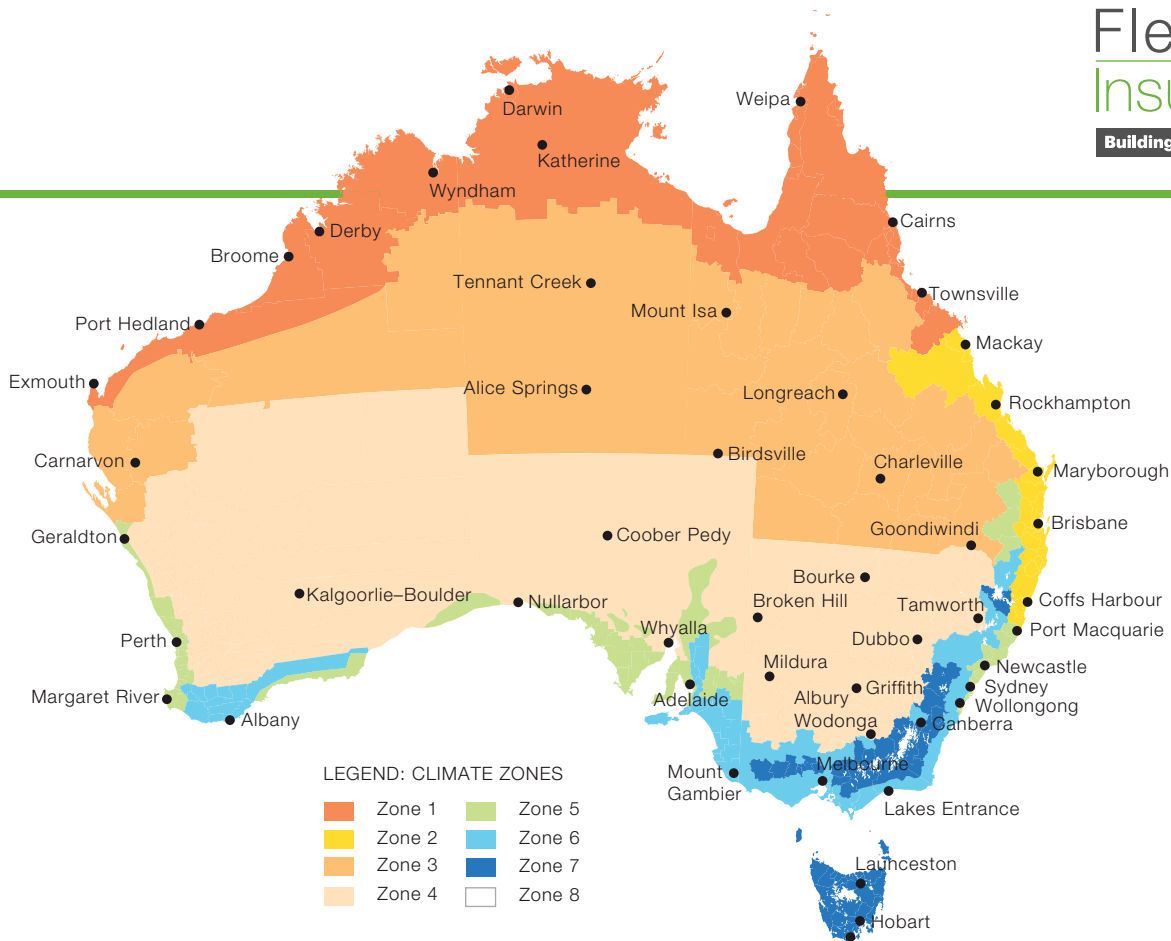

Specifier Advisory Services

Specifying the most efficient and cost-effective thermal and acoustic insulation products to be used in a building can be a daunting task. Architects, Specifiers and Building Certifiers are faced with an overwhelming range of products and brands and have to meet stringent requirements prescribed by the National Construction Code (NCC) and Australian Standards, especially in relation to energy efficiency. On top of this they have to bear in mind the cost and often the aesthetic value of the products they specify or approve.

Fletcher Insulation provides positive support for building specification professionals in two practical ways:

- 1 by being a **one-stop shop** for all their clients thermal and acoustic insulation needs;
- 2 by providing **FletcherSpec® Pro**, an **online specifier advisory service** which helps building construction professionals find the perfect insulation products for their project.

Launched in 2015, FletcherSpec® Pro has revolutionised the way in which thermal calculations pertaining to wall, floor and roof systems are generated. The software provides complete user flexibility allowing for an infinite number of system variations to be generated. Architects and Specifiers are able to develop a standard system through the use of pre-existing templates or alternatively, may opt to build a custom system from scratch. Either way, FletcherSpec® Pro provides complete guidance from start to finish prompting users when they have fulfilled relevant Deemed-to-Satisfy provisions.



Moreover, Fletcher Insulation's comprehensive insulation offering means you are able to satisfy the vast majority of your insulation specification requirements through a single provider, saving you and your client time and money.

Fletcher Insulation offers free in office group training seminars for Architects and Specifiers including CPD Training Programs.

Pink Batts®



Designed for: Thermal insulation of walls and ceilings in residential building applications. It is the trusted choice when it comes to constructing new homes or retrofitting existing buildings.

Made from: Lightweight, flexible and resilient 80% recycled glass.

- ✓ Next day delivery service available*
- ✓ Lifetime consumer warranty†
- ✓ Non-combustible in accordance with AS/NZS1530 Part 1
- ✓ Recover to their natural thickness, fast
- ✓ Batts are friction fitted and will remain in place without slumping for continual thermal performance
- ✓ Comfortable to handle during installation
- ✓ Safe to use with allergy sufferers due to low VOC
- ✓ DIY friendly
- ✓ Robust packaging will withstand the rigours of any job site



Hints

- The higher the material R-value, the more effective the insulation
- R2.5 high density wall batts are designed specifically to fit within 90mm stud
- 430mm and 580mm wide batts are designed to suit timber studs, 600mm batts are designed to suit steel studs
- Allow sufficient space for the insulation to recover to its nominal thickness to maintain its thermal effectiveness
- Can be easily cut down to requirement using a sharp retractable blade knife
- Ensure all areas are covered to avoid any thermal leakage including residential access holes

Q&A

Is stringing the external timber studs necessary when installing wall batts?

Yes, unless Sisalation® Tuffwrap™ is installed on the outside of the frame. This is to prevent the wall batts from touching the external cladding.

Will Pink Batts® fit through residential access holes?

Pink Batts® packaging is lightweight and easy to handle when lifting over head and maneuvering through tight entry points such as access holes.

How many packs do I require?

Please refer to our product ready reckoner on page 11.

System Example

Lightweight Cladding

Winter
Heat flow out
R_T 3.0

Summer
Heat flow in
R_T 2.7

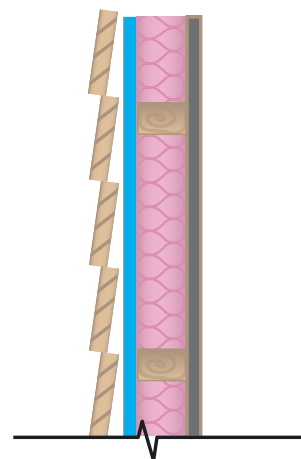

Lightweight cladding (material R-value 0.1 assumed). Directly fixed over Sisalation® Vapawrap™ or Sisalation® Tuff Wrap™ breather, bright side facing stud cavity. 90mm timber stud with Pink Batts® R2.5HD 90mm insulation installed in cavity and 10mm plasterboard lining.

*Next day delivery within branch metro areas.

† If installed as per manufacturers guidelines, check warranty information for further details.

The colour PINK, Pink® and Pink Batts® are registered trademarks of Owens Corning and used under licence by Fletcher Insulation Pty Limited.

	Material R-value	Product code	Nominal thickness mm	Width mm	Length mm	Batts per pack	m ² per pack	Coverage per pack m ²	Packs per bale
Wall	R1.5	900166	70	430	1160	24	12.0	13.6	6
		900167		580	1160	24	16.2	18.2	6
	R2.0	901217	90	430	1160	24	12.0	13.6	5
		901218		580	1160	24	16.2	18.2	5
	R2.0 HD	900210	70	430	1160	12	6.0	6.8	6
		900211		580	1160	12	8.1	9.1	6
		900213		600	1200	12	8.6	9.7	6
	R2.5 HD	900253	90	430	1160	12	6.0	6.8	5
		900256		580	1160	12	8.1	9.1	5
900214		600		1200	12	8.6	9.7	6	
Ceiling	R2.5	901254	130	430	1160	16	8.0	9.0	6
		901255		580	1160	16	10.8	12.2	6
	R3.0	901304	155	430	1160	16	8.0	9.0	5
		901305		580	1160	16	10.8	12.2	5
	R3.5	901354	175	430	1160	16	8.0	9.0	4
		901355		580	1160	10	6.7	7.6	6
	R4.0	901404	195	430	1160	10	5.0	5.6	5
		901403		580	1160	10	6.7	7.6	6
	R5.0	901504	215	430	1160	8	4.0	4.5	5
		901505		580	1160	8	5.4	6.1	5
	R6.0	901604	250	430	1160	6	3.0	3.4	5
		901605		580	1160	6	4.0	4.5	5



Pink® Floor Batts



Designed for: Use in intra-floor and subfloor applications in residential construction and is the trusted choice when it comes to constructing new homes or retrofitting existing buildings.

Made from: High density lightweight, flexible and resilient 80% recycled glass.

- ✓ Lifetime consumer warranty*
- ✓ Premium thermal rating assisting with achieving a 6 star energy rating
- ✓ Reduces cold draughts from entering the home through suspended timber floors
- ✓ Non-combustible in accordance with AS/NZS1530 Part 1
- ✓ Ease of installation, batts are friction fitted between the joists using a simple retention strap (supplied) stapled into position.
- ✓ Comfortable to handle during installation
- ✓ Safe to use with allergy sufferers due to low VOC
- ✓ DIY friendly
- ✓ Robust packaging will withstand the rigours of any jobsite
- ✓ Designed for all year round home comfort reducing energy consumption and saving you money

Hints

- When used in conjunction with the supplied unique retention strap this allows the batts to deliver their full thermal efficiency
- Keep a minimum clearance of 50mm from heat emitting devices and electrical wiring
- Can be easily cut down to requirement using a sharp retractable blade knife
- Ensure all areas are covered to avoid any thermal leakage

Q&A

What is the availability?

Availability varies from next day delivery to 10 working days plus transit time. Consult your local branch for availability and lead times.

Install Example

Timber Subfloor

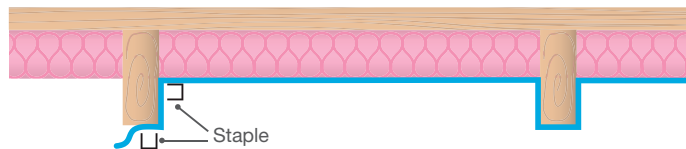

Material R-value	Product code	Nominal thickness mm	Width mm	Length mm	Batts per pack	m ² per pack	Coverage per pack m ²	Packs per bale
R2.5	900260	90	430	1160	12	5.98	6.8	5

* If installed as per manufacturers guidelines, check warranty information for further details.

The colour PINK, Pink® and Pink Batts® are registered trademarks of Owens Corning and used under licence by Fletcher Insulation Pty Limited.

How many packs of Batts will I need?

Material R-Values		R1.5, R2.0		R2.0 (HD), R2.5 (HD) Pink [®] Floor Batts			R2.5, R3.0, R3.5 [#]		R3.5 [#] , R4.0		R5.0		R6.0	
Timber Centres mm		450	600	450	600	600	450	600	450	600	450	600	450	600
Batt Size mm x mm		1160 x 430	1160 x 580	1160 x 430	1160 x 580	1200 x 600	1160 x 430	1160 x 580	1160 x 430	1160 x 580	1160 x 430	1160 x 580	1160 x 430	1160 x 580
Batts Per Pack		24	24	12	12	12	16	16	10	10	8	8	6	6
Wall / Ceiling Area		Number of packs required												
Sq.	m ²													
5	47	4	3	7	3	3	5	4	8	6	10	8	14	10
6	56	4	3	8	3	3	6	5	10	7	12	9	16	12
7	65	5	4	10	4	4	7	5	12	9	14	11	19	15
8	74	6	4	11	4	4	8	6	13	10	16	12	22	17
9	84	6	5	13	5	5	9	7	15	11	19	14	25	19
10	93	7	5	14	5	5	10	8	17	12	21	15	27	21
11	102	8	6	15	6	6	11	8	18	13	23	17	30	23
12	111	8	6	17	6	6	12	9	20	15	25	18	33	25
13	121	9	7	18	7	7	13	10	22	16	27	20	36	27
14	130	10	7	19	7	7	14	11	23	17	29	21	38	29
15	139	10	8	21	8	8	15	11	25	18	31	23	41	31
16	149	11	8	22	8	8	17	12	27	20	33	24	44	33
17	158	12	9	24	9	9	18	13	28	21	35	26	46	35
18	167	13	9	25	9	9	19	14	30	22	37	27	49	37
19	177	13	10	26	10	10	20	15	32	23	39	29	52	39
20	186	14	10	28	10	10	21	15	33	24	41	30	55	41

#R3.5 x 430 are 16 piece packs, R3.5 x 580 are 10 piece packs.

Pink® Soundbreak®



Designed for: Use as superior acoustic control in residential wall, ceiling and intra-floor applications. It is the premium choice when it comes to constructing new homes or retrofitting existing buildings with high performance thermal and acoustic efficiency in mind.

Made from: High density, lightweight, flexible and resilient 80% recycled glass.

- ✓ Pink® Soundbreak® includes all the features and benefits of our Pink Batts® range plus the extra thermal benefit and superior acoustic performance
- ✓ Lifetime consumer warranty*
- ✓ Reduces sound transfer from the external environment into your home or between adjacent rooms
- ✓ Ideal sound absorption for theatre rooms, bathrooms and other noisy living areas
- ✓ Designed for improved all year round home comfort reducing energy consumption for additional savings
- ✓ Comfortable to handle during installation
- ✓ Safe to use with allergy sufferers due to low VOC

Q&A

How efficient is Pink® Soundbreak® for use as an acoustic barrier?

The National Construction Code (NCC) has adopted the Weighted Sound Reduction Index (Rw) as a measure of the sound isolating properties of building elements. A wall system with a higher Rw rating isolates sound better than a wall system with a lower Rw rating. An increase of 10 points in an Rw rating indicates a doubling in perceived sound isolating performance.

Typically an internal wall on 90mm timber studs containing 13mm standard plasterboard on either side will achieve Rw 32. Incorporating Pink® Soundbreak® acoustic insulation within the stud cavity will typically enhance the performance of this system to Rw 42. That is an increase of 10 points in Rw rating - a doubling in perceived sound isolating performance.

To put this into context further, consider the following:

- At Rw 25, normal speech can be heard easily
- At Rw 30, loud speech can be heard easily
- At Rw 35, loud speech can be heard but not understood
- At Rw 42, loud speech can be heard only as a murmur

Source: USG Boral Systems+ April 2015.

Acoustic Example

Timber Stud Wall

Rw 32

At Rw 30, loud speech can be heard easily

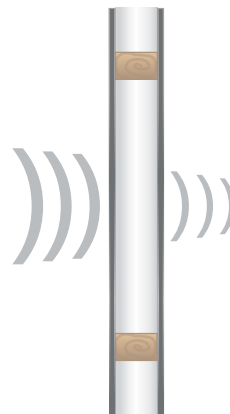

90mm timber studs & 13mm standard plasterboard on either side.

Rw 42

At Rw 42, loud speech can be heard only as a murmur

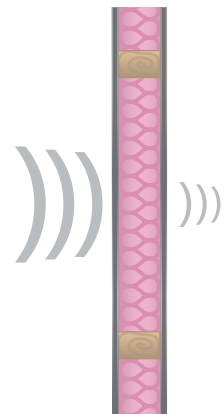

90mm timber studs with Pink® Soundbreak® within the cavity & 13mm standard plasterboard on either side

* If installed as per manufacturers guidelines, check warranty information for further details.

The colour Pink, Pink® and Pink Batts® are registered trademarks of Owens Corning and used under licence by Fletcher Insulation Pty Ltd.

Material R-value	Product code	Nominal thickness mm	Width mm	Length mm	Batts per pack	m ² per pack	Coverage per pack m ²	Packs per bale
R1.7	902191	60	430	1160	12	5.99	6.9	5
	902192		580	1160		8.07	9.1	
R2.0	902193	70	430	1160	10	4.99	5.6	5
	902194		580	1160		6.73	7.6	
	902195		600	1200		7.20	7.2	
R2.5	902196	90	430	1160	8	3.99	4.5	5
	902197		580	1160		5.38	6.1	
R2.7	902198	90	430	1160	8	3.99	4.5	5
	902199		580	1160		5.38	6.1	
	902200		600	1200		5.76	5.8	
R3.1	902201	110	430	1160	6	2.99	3.4	5
	902202		580	1160		4.04	4.5	



Polyester Thermal Batts



Designed for: Thermal insulation of walls and ceilings in residential constructions.

Made from: 100% pure polyester from 45% recycled PET plastics.

- ✓ 10 year product warranty
- ✓ Easy installation, can be torn straight across its width
- ✓ Safe to use with allergy sufferers due to low VOC
- ✓ No ozone depleting substances or gases
- ✓ Designed for all year round home comfort reducing energy consumption and saving you money

Hints

- The higher the material R-value, the more effective the insulation
- Allow sufficient space for the insulation to recover to its nominal thickness to maintain its thermal effectiveness. Polyester Batts can take up to a month to recover or longer if stored for too long. Manufacturer recommends to install polyester batts within 6 months of purchase

Q&A

What is the availability of polyester batts?

Availability varies from next day delivery to 10 working days plus transit time. Consult your local branch for availability and lead times.

How do I dispose of left over polyester batts once I have finished installing the insulation in my home?

Polyester batts are 100% recyclable including the packaging.

	Material R-value	Product code	Nominal thickness mm	Width mm	Length mm	Batts per pack	m ² per pack	Coverage per pack m ²
Walls	R1.0	335104	75	430	1160	21	10.47	12.05
		335105		580	1160		14.13	15.47
	R1.5	335154	90	430	1160	16	7.98	9.20
		335155		580	1160		10.76	12.40
	R2.0	335204	90	430	1160	12	5.99	6.90
		335207		580	1160		8.07	9.30
	R2.5	335264	90	430	1160	6	2.99	3.40
		335265		580	1160		4.04	4.60
Ceilings	R2.0	335204	120	430	1160	12	5.99	6.90
		335207		580	1160		8.07	9.30
	R2.5	335254	165	430	1160	8	3.99	4.60
		335255		580	1160		5.38	6.20
	R3.0	335304	185	430	1160	8	3.99	4.60
		335305		580	1160		5.38	6.20
	R3.5	335354	200	430	1160	6	2.99	3.40
		335355		580	1160		4.04	4.60
	R4.0	335404	210	430	1160	4	1.99	2.30
		335405		580	1160		2.69	3.10

Polyester Underfloor Batts



Designed for: Use in intra-floor and subfloor applications in residential constructions

Made from: 100% pure polyester from 45% recycled PET plastics

- ✓ 10 year product warranty
- ✓ Stabilises room temperature by preventing up to 15% of energy leakage through the floor
- ✓ Effective acoustic absorption for tranquil living
- ✓ Reduces cold draughts from entering the home through suspended timber floors
- ✓ Easy installation, can be directly stapled* to the underfloor and torn straight across its width
- ✓ Designed for all year round home comfort reducing energy consumption and saving you money

Hints

- The higher the material R-value, the more effective the insulation
- Allow sufficient space for the insulation to recover to its nominal thickness to maintain its thermal effectiveness, Polyester Batts can take up to a month to recover or longer if stored for too long. Install polyester batts within 6 months of purchase
- Ensure all areas are covered to avoid any thermal leakage

Q&A

What is the availability?

Availability varies from next day delivery to 10 working days plus transit time. Consult your local branch for availability and lead time.

How do I dispose of left over polyester batts once I have finished installing the insulation in my home?

Polyester batts are 100% recyclable including the packaging.

Install Example

Timber Subfloor

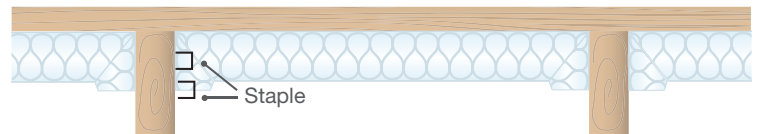

Material R-value	Product code	Nominal thickness mm	Width mm	Length m	Batts per pack	m ² per pack	Coverage per pack m ²
R1.5	335201	90	430	11.6	3	14.96	16.46
R2.0	335200	120	450	11.6	3	15.66	17.00

Polyester Acoustic Batts



Designed for: Use as insulation for acoustic requirements in residential wall, ceiling and intra-floor applications. Suitable for use when constructing new homes or retrofitting existing buildings with thermal and acoustic efficiency in mind.

Made from: 100% pure polyester from 45% recycled PET plastics.

- ✓ Polyester acoustic batts include all the features and benefits of our polyester batts range plus the extra thermal benefit and superior acoustic performance
- ✓ 10 year product warranty
- ✓ Reduces sound transfer from the external environment into your home or between adjacent rooms
- ✓ Ideal sound absorption in theatre rooms, bathrooms and other noisy living areas
- ✓ Easy installation, can be torn straight across its width
- ✓ Safe to use with allergy sufferers due to low VOC

Q&A

How do I dispose of left over polyester batts once I have finished installing the insulation in my home?

Polyester batts are 100% recyclable including the packaging.

What is the availability?

Availability varies from next day delivery to 10 working days plus transit time. Consult your local branch for availability and lead times.

Acoustic Example

Timber Stud Wall

Rw 32

At Rw 30, loud speech can be heard easily

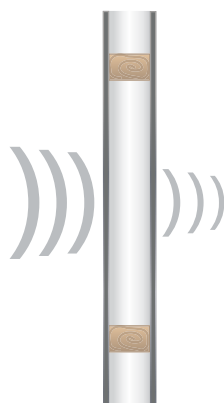

90mm timber studs with 10mm standard plasterboard on either side

Rw 36

At Rw 35, loud speech can be heard but not understood

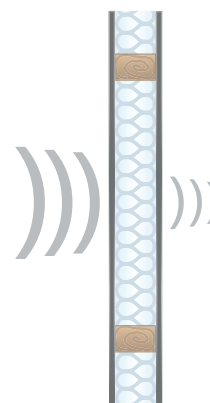

90mm timber studs with Polyester Acoustic Batts installed in the cavity & 10mm standard plasterboard on either side

Material R-value	Product code	Nominal thickness mm	Width mm	Length mm	Batts per pack	m ² per pack	Coverage per pack m ²
R1.5	335074	75	430	1160	8	3.99	4.60
R1.5	335075	75	580	1160	8	5.38	6.20
R2.0	335094	90	430	1160	8	3.99	4.60
R2.0	335095	90	580	1160	8	5.38	6.20
R2.5	335014	100	430	1160	8	3.99	4.60
R2.5	335015	100	580	1160	8	5.38	6.20
R4.5	335024	200	430	1160	4	2.00	2.30
R4.5	335025	200	580	1160	4	2.69	3.10

Sisalboard® Expanded Polystyrene (EPS)

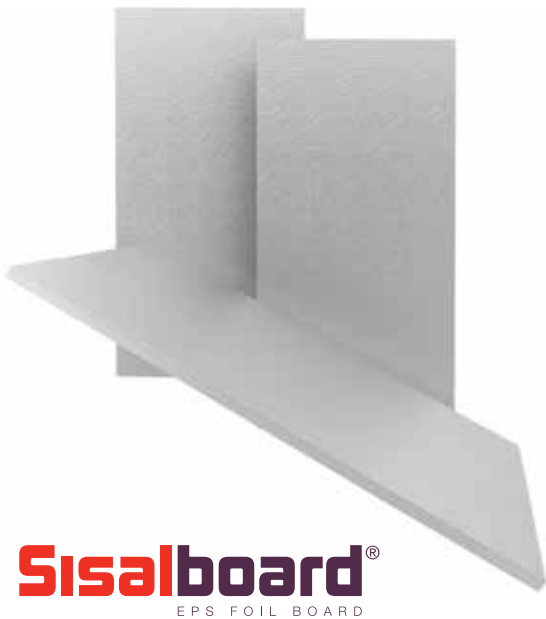

Sisalboard®
EPS FOIL BOARD

Designed for: Use in new and existing construction works. Primarily used as a membrane to cover external studwork, infill cavities of double brick walls to provide improved thermal, vapour barrier and draft sealing properties when joins are taped.

Made from: Expanded polystyrene core coated with an anti-glare foil facing on one side and a reflective foil laminate on the other, forming a rigid board.

- ✓ 10 year product warranty
- ✓ Features two low emissivity surfaces to allow for increased total R-value performance
- ✓ Reflects up to 95% radiant heat, allowing for cooler internal conditions in hot and humid climates
- ✓ Suitable for use as a thermal break for steel framed constructions in accordance with NCC requirements
- ✓ Incorporates an anti-glare coating on one side for added install safety
- ✓ High compressive strength
- ✓ Light weight, rigid foam composition allows for ease of installation
- ✓ Eliminates the need for extra deep framing
- ✓ High resistance to heat flow (i.e. low thermal conductivity)
- ✓ Performance is not adversely affected by contact with water
- ✓ Environmentally friendly (no CFC's are used in manufacture)
- ✓ Uniform density distribution for dimensional stability

Hints

- Formerly known as InsulBoard
- The blue anti-glare side faces outwards from the dwelling to avoid sun glare when installing
- Leaving an airspace can provide an additional R-value by retarding radiant heat flow, refer to FletcherSpec® Pro for further specification details
- Use Vapastop® 883 foil tape to seal the exposed ends of the sheet and / or around the brick ties if wanting to achieve a full vapour proof barrier
- When taping joins, use a plastic squeegee to assist in applying an appropriate amount of pressure along the seam of the tape
- Can be easily cut down to requirement using a sharp retractable blade knife

Q&A

What is the availability?

Availability varies from next day delivery to 10 working days plus transit time. Consult your local branch for availability and lead times.

System Example

Double Brick Wall

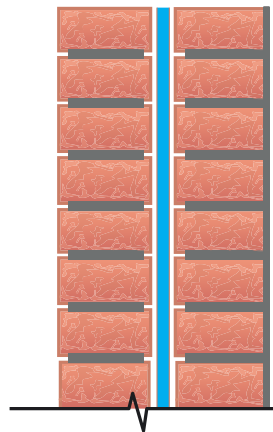

Winter
Heat flow out
R_T 2.1

Summer
Heat flow in
R_T 2.0

Double brick wall with 50mm brick cavity with 15mm Sisalboard Bright side facing inwards. 20mm non-vented air space on each side. Render / 10mm plasterboard.

Material R-value	Product code	Nominal thickness mm	Width mm	Length mm
0.25	328110	10	1200	2400
	328112		1200	2700
0.37	328115	15	1200	2400
	328113		1200	2700
0.5	328120	20	1200	2400
	328114		1200	2700
0.63	328126	25	1200	2400
0.75	328130	30	1200	2400
1.25	328135	50	1200	2700

PIRFORMATHERM®

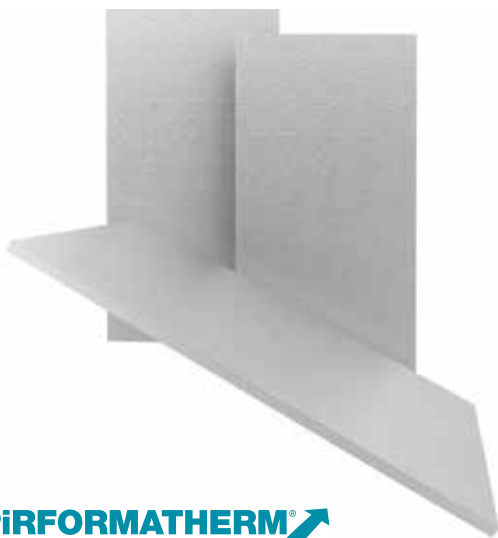

Designed for: Use in buildings as a continuous thermal, reflective and moisture barrier across various applications including, but not limited to soffit, stud/masonry/cavity wall, vaulted ceilings, attics and spaces where high insulation values are required.

Made from: Thermoset polyisocyanurate foam core with a reflective foil laminate on one side and kraft paper or reflective foil laminate on the other side forming a rigid board.

- ✓ 10 year product warranty
- ✓ Excellent fire retardant properties
- ✓ Uniform density distribution for dimensional stability
- ✓ High compressive strength
- ✓ Lightweight, rigid foam composition allows for ease of installation
- ✓ Eliminates the need for extra deep framing
- ✓ Superb water vapour performance
- ✓ Environmentally friendly (no CFC's are used in manufacture)
- ✓ Low emissivity foil facings offering enhanced thermal performance within cavity airspaces
- ✓ Available in custom lengths and facing to improve installation efficiency

Hints

- Provides equally impressive fire resistance characteristics, dramatically reducing the hazards associated with some insulation foams that melt at low temperatures in the event of fire
- Custom made lengths available up to 18 metres long*
- Leaving an airspace can provide an additional R-value by retarding radiant heat flow, refer to FletcherSpec® Pro for further specification details
- Use Vapastop® 883 foil tape to seal the exposed ends of the sheet and / or around the brick ties if wanting to achieve a full vapour proof barrier

Q&A

What is the availability?

Available by special order. Consult your local branch for minimum order quantity and lead time.

Material R-value	Product code foil / kraft paper facing	Product code foil / foil facing	Nominal thickness mm	Width mm	Length mm
1.14	395767	395751	25	1200	2400
1.36	395768	395752	30	1200	2400
1.59	395769	395753	35	1200	2400
1.82	395770	395754	40	1200	2400
2.05	395771	395755	45	1200	2400
2.27	395772	395756	50	1200	2400
2.5	395773	395757	55	1200	2400
2.73	395774	395758	60	1200	2400
2.95	395775	395760	65	1200	2400
3.18	395776	395761	70	1200	2400
3.41	395777	395762	75	1200	2400
3.64	395778	395763	80	1200	2400
3.86	395779	395764	85	1200	2400
4.09	395780	395765	90	1200	2400
4.32	395781	395766	95	1200	2400
4.55	395782	395759	100	1200	2400

System Example

Double Brick Wall

Winter
Heat flow out

R_T 2.8

Summer
Heat flow in

R_T 2.7

Double brick wall with 55mm cavity with 35mm PIRFORMATHERM® Bright side facing inwards. 20mm non-vented air space. Render / 10mm plasterboard.

*Custom made Cut to Length (CTL) boards available in lengths between 2.4-18m long. MOQ and lead times apply. Contact Fletcher Insulation for product codes relating to alternative facing options.



Designed for: Use as fire protection in party or separating wall constructions between adjacent tenancies (Class 1 buildings). They are installed between the top of a party wall and the roofing membrane to provide excellent resistance to shrinkage at high temperatures.

Made from: Natural mineralised rock fibres.

- ✓ Cost effective fire insulation
- ✓ Non-combustible in accordance with AS/NZS1530 Part 1 and Part 3 reducing fire risk
- ✓ Achieves 2 hour fire resistance, thereby preventing the transfer of fire into adjoining occupancies*
- ✓ Provide excellent resistance to shrinkage at high temperatures
- ✓ Fire performance is not adversely affected by contact with water
- ✓ Non-corrosive highly durable insulation material
- ✓ Easy to cut and install into tight applications
- ✓ Bio-soluble mineral wool and safe to use

Hints

- Ensure material is compressed by >10% when installing
- Fire Strips are used to fill voids around ductwork and other penetrations in a fire rated partition
- It is recommended that Fire Stop Party Wall batts be compression fitted when installing

Q&A

What is the availability?

Availability varies from next day delivery to 10 working days plus transit time. Consult your local branch for availability and lead times.

Install Example

Typical Party Wall and Common Wall application

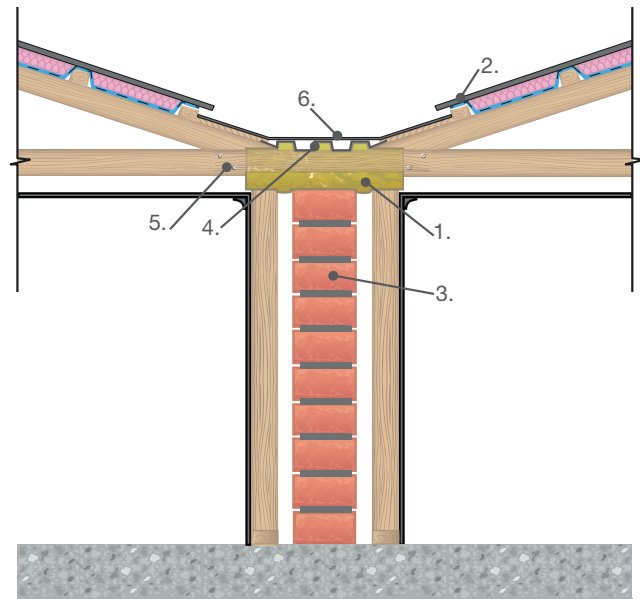

1. Party Wall Batt is compressed in place from the top of the FRL wall to the underside of non-combustible roof cladding 2. Non-combustible roof cladding 3. FRL rated wall 4. Metal deck (Spandek) box gutter support 5. Compliant roof batten to support metal deck 6. Metal box gutter.

Product	Product code	Thickness mm	Width mm	Length mm	Pieces per pack
Party Wall Batt	338005	100	168	1200	10
Party Wall Batt	338006	50	200	1000	3
Fireseal	338001	13	225	750	60
Fire Strip	338008	13	225	1000	60

*Specific construction type in accordance with specification C3.16 of the NCC. Tested by CSIRO for AS1530 Part 4.

Mass Loaded Vinyl Barrier

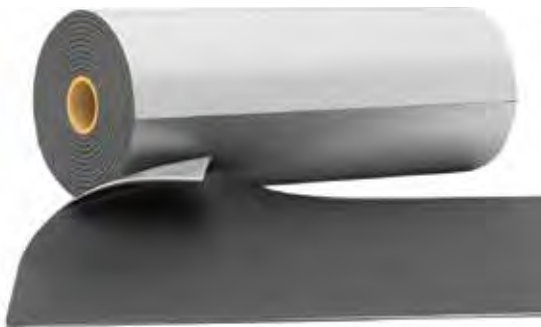

Designed for: Use in applications where space may be limited to reduce unwanted noise transmission through ceilings, walls, floors, office partitions, machinery enclosures and/or ductwork. Can also be draped to make portable acoustic curtains and screens.

Made from: Foil faced, heavy mass-loaded vinyl noise barrier with a reinforced fabric backing.

- ✓ Ideal to fabricate around pipe penetrations, ducting and cabling
- ✓ High tensile strength, resistant to tearing
- ✓ Free from lead, odour-producing oils and bitumen
- ✓ Excellent fire retardant properties
- ✓ Easy to cut, sew and mechanically fasten into position
- ✓ Resistant to most chemicals, solvents and petrol
- ✓ Safe to use with allergy sufferers due to low VOC
- ✓ Reduces sound transfer from the external roof environment into the building (i.e. rain and overhead traffic)
- ✓ Ideal for home theatre rooms, office partitions and meeting rooms
- ✓ Can be wrapped around noisy pipes, i.e. fluid or gas pulsation in chemical, petrochemical and waste water treatment plants
- ✓ Can be installed around the outside of metal air ducts to reduce noise breaking out
- ✓ Can be laminated onto lightweight structures to dampen vibration and reduce airborne noise

Hints

- Can be easily cut down to requirement using a sharp retractable blade knife
- Also known as Soundbaffle
- Avoid long term exposure over 150°C
- The foil facing also allows reinforced foil tapes to be used to join two pieces of Mass Loaded Vinyl Barrier together when overlapped

Q&A

What is the availability?

Availability varies from next day delivery to 10 working days plus transit time. Consult your local branch for availability and lead times.

What installing techniques can I use?

Material can be nailed, screwed, stapled or can be reinforced, grommeted and hung like a curtain.

Acoustic Example

Timber Stud Wall

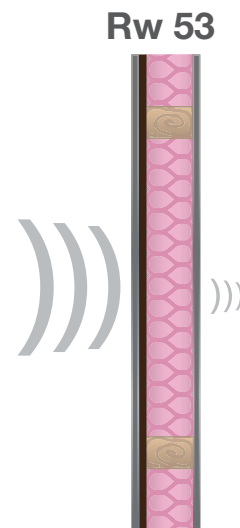

90mm timber studs with Pink® Soundbreak® within the cavity & 6kg/m² Mass Loaded Vinyl Barrier on one side of the studs covered by 13mm standard plasterboard on either side

Barrier weight kg/m²	Product code	Thickness mm	Width mm	Length m	m² per roll	Roll weight kg	Rolls per pallet
4	330014	2.0	1350	5	6.7	27	20
6	330006	3.0	1350	5	6.7	41	20
8	330008	4.0	1350	5	6.7	54	30

Other options maybe available, consult your branch for availability and lead times.

Pink® and Pink Batts® are registered trademarks of Owens Corning used under licence by Fletcher Insulation Pty Ltd.

Pipe Acoustic Lagging



Designed for: Use around ducts, rainwater or waste pipes to reduce noise levels. Satisfies NCC requirements for habitable areas in residential and multi-residential buildings.

Made from: Reinforced aluminium foil skin applied to a 5kg/m² flexible loaded vinyl barrier backed with 20mm thick convoluted, hydrolysis resistant, acoustic foam.

- ✓ Maximises noise control by providing high sound absorption (reverberation control) and superior transmission loss
- ✓ Highly flexible, allowing it to conform to the smallest diameter pipes & bends (has no memory)
- ✓ Conforms well to corners and irregular surfaces
- ✓ Excellent fire retardant properties
- ✓ Broad operating temperature range; max 120°C
- ✓ High resistance to heat flow (i.e. low thermal conductivity)
- ✓ Reduces the noise in hydraulic and waste pipes by up to 25dB(A)
- ✓ Performance is not adversely affected by contact with water
- ✓ Easy to cut and install into tight applications
- ✓ Safe to use with allergy sufferers due to low VOC
- ✓ Resistant to bacteria and micro-organism growth

Hints

- Also known as Soundlag 4525C
- To satisfy NCC requirements the duct or waste pipe must be separated from the rooms of any sole-occupancy unit by construction with an Rw+Ctr (airborne) not less than 40 if the adjacent room is a habitable room
- Can be easily cut down to requirement using a sharp retractable blade knife

Q&A

What is the availability?

Availability varies from next day delivery to 10 working days plus transit time. Consult your local branch for availability and lead times.

Noise radiating from piping and ductwork is a serious issue in modern building construction. How does Pipe Acoustic Lagging solve this?

With just one wrap around the pipe using Pipe Acoustic Lagging sealed with Vapastop[®] 883 reinforced tape and the addition of a 10mm plasterboard ceiling, the construction will meet and exceed the NCC standards for habitable areas. (Part F5.6 class 2 and 3).

Acoustic Example

Water Waste Pipe



Barrier weight kg/m ²	Product code	Thickness mm	Width mm	Length m	m ² per roll	Roll weight kg	Rolls per pallet
5	330025	25	1350	5	6.70	30	50
5	330026	25	1350	3	4.05	18	50

Other options may be available, consult your branch for availability and lead times.

Permastop® Building Blanket



PERMASTOP®
Making metal roofs better

Designed for: Use in residential and commercial metal clad roof and wall applications to provide condensation protection, while also providing excellent thermal and acoustic benefits for the building.

Made from: Reflective insulation composite comprising of a Pink® glasswool blanket substrate that is faced on one side with a high quality Sisalation® reflective foil laminate.

- ✓ Next day delivery service available*
- ✓ 10 year product warranty
- ✓ Aids in minimising the risk of condensation
- ✓ Satisfies Bushfire Attack Level (BAL) requirements of 0-40 in roof applications and 0-FZ in wall applications (in accordance with AS3959 – 2009)
- ✓ Reduces sound transfer from the external environment (i.e. rain and overhead traffic) into the building
- ✓ Designed for all year round comfort reducing energy consumption and saving you money
- ✓ Manufactured from up to 80% recycled glass
- ✓ Faced with industry leading Sisalation® reflective foil laminate in your choice of Light, Medium or Heavy duty strength
- ✓ 150mm foil overlap along one side edge, for ease of installation
- ✓ Available in custom lengths to improve installation efficiency

Hints

- The higher the material R-value, the more effective the insulation
- A heavier duty foil provides increased strength and is therefore less likely to be damaged over time or during installation
- Allow sufficient space for the insulation to recover to its nominal thickness to achieve its designed effectiveness
- For spans greater than 900mm, support (safety mesh or the like) must be provided below the Permastop® Building Blanket
- Permastop® Building Blanket is not a sarking membrane, hence should not be lapped into the gutter
- The product is not suitable for applications where subject to wetting or excessive moisture
- Can be easily cut down to requirement using a sharp retractable blade knife

Q&A

What way should Permastop® Building Blanket be rolled out when installing?

Permastop® Building Blanket is typically installed with the reflective surface facing downwards into the air-space below; except in hot and humid tropical regions where the reflective foil is typically installed on the underside of the metal roof sheet. In such conditions, where the building blanket is used in an exposed application, Fletcher Insulation recommends installing the blanket as per standard procedures and running an additional layer of anti-glare foil laminate on top of the blanket under the metal roof sheet. This allows for an enhanced aesthetic finish.

*Next day delivery for stocked items within branch metro areas.

The colour PINK, Pink® and Pink Batts® are registered trademarks of Owens Corning and used under licence by Fletcher Insulation Pty Limited.

Facing	Material R-value	Product code	Nominal thickness mm	Width mm	Length m	m ² per roll
Sisalation [®] 436 Facing Foil Light Duty (LD) 150mm lap	R1.3	912150	55	1200	15	18
		912200		1200	20	24
	R1.4	910150†	60	1200	15	18
		910120†		1200	20	24
	R1.8	913150	75	1200	15	18
	R2.3	914163	100	1200	10	12
	R2.5	914100	100	1200	10	12
	R3.0	930100	130	1200	10	12
	R3.2	930101	130	1200	10	12
R3.6	930368	130	1200	6.5	7.8	
Sisalation [®] 430 Facing Foil Medium Duty (MD) 150mm lap	R1.3	917150	55	1200	15	18
	R1.4	930366†	60	1200	15	18
	R1.8	918150	75	1200	15	18
	R2.3	911471	100	1200	10	12
	R2.5	919100	100	1200	10	12
	R3.0	931100	130	1200	10	12
	R3.2	930201	130	1200	10	12
	R3.6	930362	130	1200	6.5	7.8
Sisalation [®] 450 Facing Foil Heavy Duty (MD) 150mm lap	R1.3	927150	55	1200	15	18
	R1.4	930365†	60	1200	15	18
	R1.8	928150	75	1200	15	18
	R2.3	928163	100	1200	10	12
	R2.5	929100	100	1200	10	12
	R3.0	932100	130	1200	10	12
	R3.2	930301	130	1200	10	12
	R3.6	930367	130	1200	6.5	7.8

† Available to Brisbane and Townsville metro areas for next working day delivery service only.

Other made to order (MTO) options and facings maybe available, consult your branch for availability and lead times.

System Example

Pitched Metal Roof

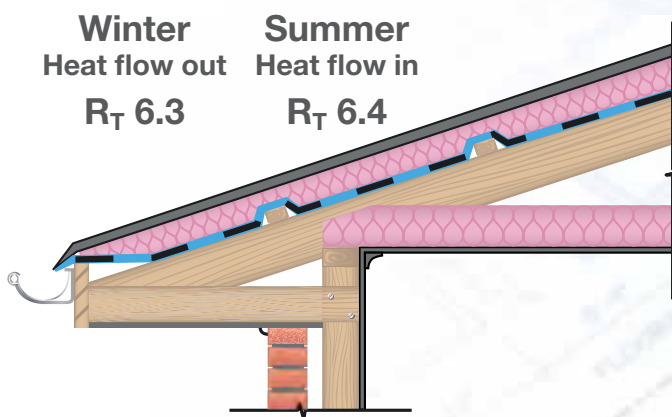

Pitched metal roof laid between 18° and 35°, R1.8 Permastop[®] 75mm over battens, foil facing attic. Pink Batts[®] R3.5 175mm insulation, positioned between joists on 10mm plasterboard lining.

Fletcher Spec[®] pro

Download
FletcherSpec[®] Pro
TODAY

Calculate your total R-value
in just a few clicks
www.insulation.com.au/fletcherspec



Pink® EmberGuard® Building Blanket

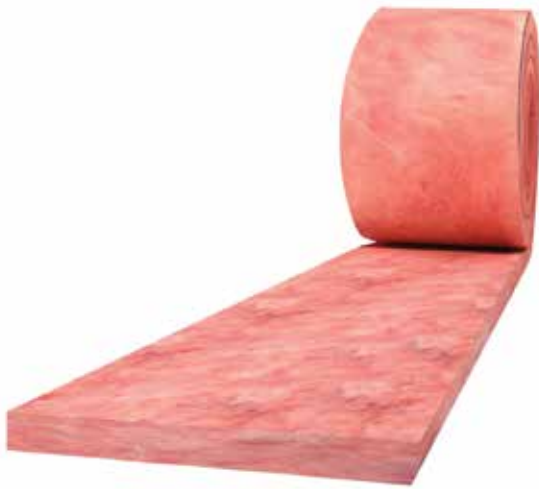

Designed for: Use under metal and tiled roofing elements in residential constructions. Compress blanket to seal gaps under the corrugations or ribs and between roof components in accordance with the bushfire construction requirements of AS3959-2009 Clause 5.6.3 which must be installed in conjunction with Sisalation® Multipurpose EHD or Sisalation® Metal Roof.

Made from: Lightweight, flexible and resilient 80% recycled glass.

- ✓ Next day delivery service available*
- ✓ 10 year product warranty
- ✓ Non-combustible in accordance with AS1530.1 - 1994 reducing fire risk
- ✓ For use in bushfire prone areas with a Bushfire Attack Level (BAL) of 12.5 - 40 (Ember Attack)
- ✓ Cost effective regulatory compliant solution providing peace of mind against ember attack

Hints

- Alternate sarking solutions may be used in conjunction with Pink® EmberGuard®, refer to product data sheet for further details
- The product is not suitable for applications where subject to wetting or excessive moisture.
- Ember attack can occur over distances greater than 100 metres from the fire front, additionally any gaps or areas where embers can enter in from reduces a buildings resistance to bushfire attack
- Can be easily cut down to requirement using a sharp retractable blade knife
- The Victorian Building Amendment (Bushfire Construction) Regulation 2011, requires all new homes built in bushfire prone areas to be built to a minimum BAL (Bushfire Attack Level) of 12.5, including protection against ember attack

Q&A

Where should Pink® EmberGuard® Building Blanket be installed?

Pink® EmberGuard® building blanket is to be installed between gaps that occur at ridge capping, valleys and fascias of metal and tiled roofs.

Install Example

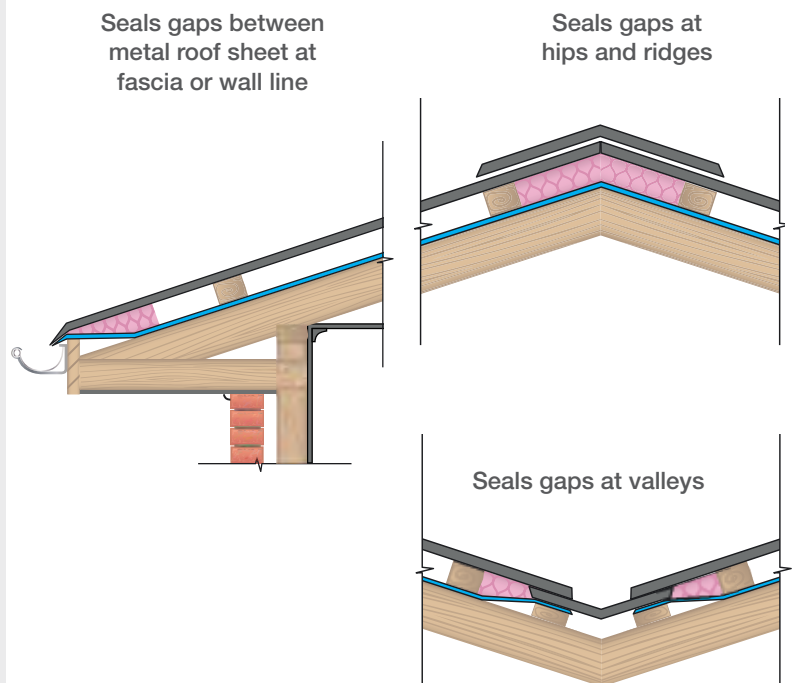

Product code	Nominal thickness mm	Width mm	Length m	Batts per pack	L/M per pack
910242	25	300	20	4	80

*Next day delivery within branch metro areas.

Pink® and Pink Batts® are registered trademarks of Owens Corning used under licence by Fletcher Insulation Pty Ltd.



Designed for: Use as a wall wrap building membrane for timber and steel framed walls and gables which assists in minimising draughts enabling bulk insulation to perform more effectively. The 'Breather' variant is better suited for use behind permeable lightweight cladding such as fibre cement sheets, weatherboard and timber[†].

Made from: A layer of reflective foil bonded to a polymer-based weave.

- ✓ Next day delivery service available*
- ✓ 10 year product warranty
- ✓ Satisfies Bushfire Attack Level (BAL) requirements of 0-FZ in wall applications (in accordance with AS3959 – 2009)
- ✓ Designed to protect buildings by reflecting 95% of radiant heat
- ✓ Incorporates an anti-glare coating on one side for added installation safety
- ✓ Minimises the amount of moisture absorbed by the frame during construction
- ✓ Exceptional strength to weather and tearing

Hints

- When installed adjacent to a minimum 20mm air space the reflective surface provides increased thermal performance and contributes to the overall energy efficiency of the building
- By overlapping and sealing with Vapastop® 883 aluminium tape, it provides the dwelling with an extra tough barrier against outside elements enabling the commencement of inside works such as plumbing, electrical and bulk insulation to commence immediately before construction of the outer skin has commenced
- Store in a cool dry place, away from alkaline corrosive materials such as concrete and lime

Q&A

What way do I install the wall wrap?

Wall wrap has an anti-glare blue facing which is installed facing outwards from the building to protect the installers eyes from the harsh rays of the sun.

How do you fix wall wrap to steel frame?

Use double sided tape or wafer head screws.

Install Example



Product	Product code	Width mm	Length m	m ² per roll	Roll weight kg
Sisalation® 497 Tuff Wrap™ Standard	255088	1350	30	40.5	4.3
	255092		60	81	9
	255385	1500	30	45	4.7
Sisalation® 497 Tuff Wrap™ Breather	255089	1350	30	40.5	4.5
	255087		60	81	9
	255393	1500	30	45	4.7

[†] It is important that the cladding manufacturer's requirements are referred to when determining the suitability of Sisalation® 497 Tuff Wrap™ Breather.

* Next day delivery within branch metro areas.

Permeable Membranes



Designed for: Use in colder regions as a vapour permeable membrane to manage condensation. Provides superior protection against damaging winds and heavy rain which can penetrate through exterior cladding and roofing material. Vapawrap™ and HomeWrap® will keep bulk water out, allowing moisture vapour inside the structure to escape.

- ✓ Next day delivery service available*
- ✓ 10 year product warranty
- ✓ Satisfies Bushfire Attack Level (BAL) requirements of 0-40 in roof applications and 0-FZ in wall applications (in accordance with AS3959 – 2009)
- ✓ Light and easy to handle while exhibiting high strength and durability
- ✓ Provides in-built breathability and superior hold out to wind and water
- ✓ Greater heat shrink resistance compared to traditional polymer-weave based membranes
- ✓ Allows internal building works to commence once the roof has been installed; thereby allowing for expedited project completion
- ✓ Prevents bacteria and micro-organism growth

Hints

- Permeable Membranes are not designed to withstand prolonged weathering, hence the external cladding should be applied within 4 months of installation
- Sisalation® Vapawrap™ Metal Roof is specially designed for use in metal roof applications and is typically laid over Permastop® Building Blanket
- Product must not be installed in areas where winds exceed 120kph
- Product is required to be fixed to frame using tool fasteners every 600mm horizontally and every 600mm vertically, or by using staples and strapping every 600mm

Q&A

Do Permeable Membranes have an R-value?

No; however, properly installed Permeable Membranes will help protect against loss of R-value in wall insulation due to wind washing. Even at wind speeds of 5mph, a wall without an air barrier retains less than 40% of its original installed R-values.

Can I use Permeable Membranes for under roof applications?

Sisalation® Vapastop™ Metal Roof is designed for use under metal roof constructions. It is typically installed over Permastop® Building Blanket protecting the insulation against wind washing and water penetration.

Install Example

Lightweight Cladding

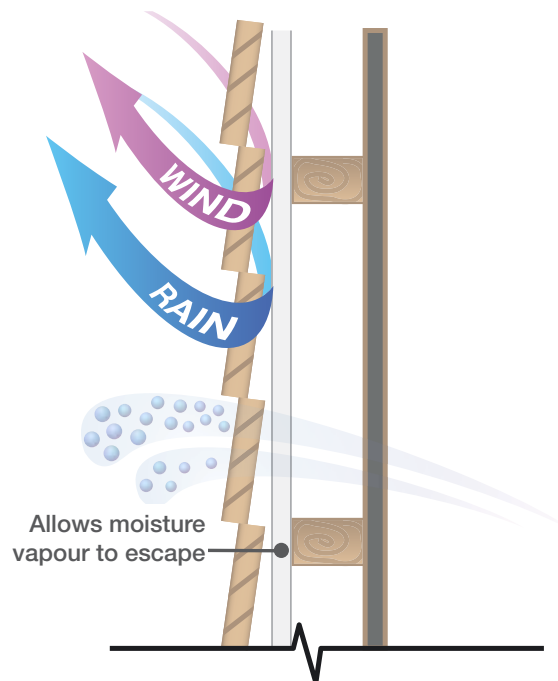

Product	Product code	Width mm	Length m	m ² per roll	Roll weight kg
Sisalation® Vapawrap™ Wall	395356	1350	30	40.5	4.8
Sisalation® Vapawrap™ Metal Roof	395357	1250	40	50	11.1
Tyvek® HomeWrap®	395121	2742	30	82	5.1
	395994	3048	30	91.4	5.6

Install using flashing tape to seal door and window frames and tape to seal joints.

Product	Product code	Width mm	Length m	Rolls per carton
Dupont® Flashing Tape	395993	101	30.48	4
Tyvek® Contractor Tape	318053	48	50	36

Dupont®, Tyvek® and HomeWrap® are registered trademarks of Dupont (Australia) Ltd.

*Products are available for next day delivery for branches located within suitable climate zones. All other branches are subject to lead times.



Sisalation® Tile Roof



Designed for: Use as a sarking in residential concrete and terracotta tiled roof construction with the exception of slate.

Made from: Single sided reflective foil kraft paper laminate bonded to polymer weave.

- ✓ Next day delivery service
- ✓ 10 year product warranty
- ✓ Strong, tear and scratch resistant
- ✓ Protects homes and buildings against radiant heat
- ✓ Incorporates an anti-glare coating on one side for added install safety
- ✓ Suitable for installation in areas prone to high or seasonal winds
- ✓ Resistant to puncturing and tearing during installation of roof tiles which can result in rain ingress
- ✓ Provides protection against moisture content fluctuation of timber trusses, thus minimising the chance of nail plate pull-out
- ✓ Minimises draughts, thereby allowing bulk wall insulation to perform more effectively
- ✓ Suitable for use in bushfire areas with a Bushfire Attack Level (BAL) of 0 – 40 in accordance with AS 3959-2009

Hints

- To maximise performance and service life allow a 40mm sag between roof rafters
- When installed adjacent to a minimum 20mm air-space the reflective surface provides increased thermal performance and contributes to the overall energy efficiency of the building
- When overlapped and sealed using Vapastop® 883 aluminium foil tape, provides the dwelling with an effective secondary skin against moisture, vapour, wind, heat and dust penetration into the roof cavity
- Store upright in a cool dry place, away from alkaline corrosive materials such as concrete and lime

Q&A

Can sarking be retrofitted under existing concrete and terracotta tile roofs?

Typically Sisalation® Tile Roof is to be installed at the time of the building construction phase, however can also be installed to existing buildings should the roof be replaced.

Install Example

Tiled Roof with Timber Battens



Product	Product code	Width mm	Length m	m ² per roll	Roll weight kg
Sisalation® 465 Tile Roof Heavy Duty	952299	1500	30	45	10.8

*Next day delivery within branch metro areas.



Designed for: Use as a sarking in residential metal roof construction

Made from: Double sided reflective aluminum foil one side with an anti-glare coating, double layered high density kraft paper. HD option is reinforced by yarn.

- ✓ Next day delivery service available*
- ✓ 10 year product warranty
- ✓ Strong, tear and scratch resistant
- ✓ Protects buildings against radiant heat
- ✓ The foil-paper composition reduces the risk of noise generated in metal roofs (otherwise known as “noisy roof syndrome”)
- ✓ Incorporates an anti-glare coating on one side for added installation safety
- ✓ Minimises draughts, thereby allowing bulk wall insulation to perform more effectively
- ✓ Suitable for use in bushfire areas with a Bushfire Attack Level (BAL) of 0 – 40 in accordance with AS3959-2009

Hints

- To maximise performance and service life allow a 40mm sag between battens
- When installed adjacent to a minimum 20mm air space the reflective surface provides increased thermal performance and contributes to the overall energy efficiency of the building
- When overlapped and sealed using Vapastop® 883 aluminium foil tape, provides the dwelling with an effective secondary skin against moisture, vapour, wind, heat and dust penetration into the roof cavity
- Store in a cool dry place, away from alkaline corrosive materials such as concrete and lime

Q&A

Can sarking be retrofitted under existing metal roofs?

Typically Sisalation® Metal Roof is to be installed at the time of the building construction phase. However it can also be installed to existing buildings should the roof be replaced.

Install Example

Metal Roof with Metal Battens

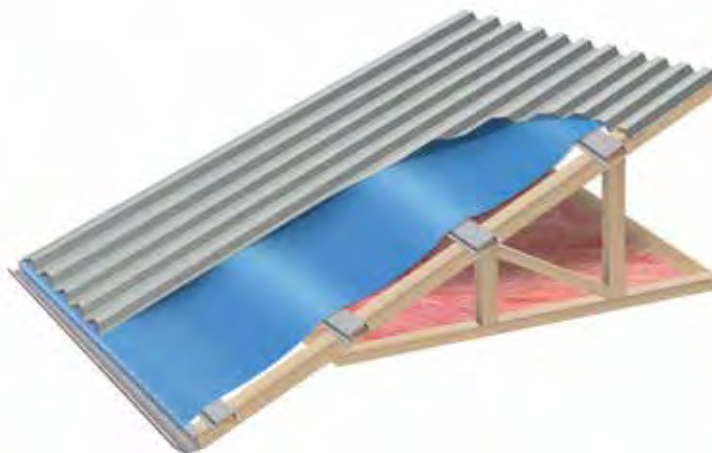

Product	Product code	Width mm	Length m	m ² per roll	Roll weight kg
Sisalation® 433 Metal Roof Medium Duty	951282	1350	30	40.5	12.86
	951260		60	81	25.71
Sisalation® 453 Metal Roof Heavy Duty	952260	1350	60	81	27.8

*Next day delivery within branch metro areas.

Sisalation® Multipurpose



Designed for: Use as a pliable building membrane in residential brick veneer wall, metal roof and some tile roof applications, to provide an effective secondary skin against moisture, vapour, wind and dust penetration.

Made from: A layer of aluminium foil bonded to a polymer-based weave, EHD option is reinforced by yarn.

- ✓ Next day delivery service
- ✓ 10 year product warranty
- ✓ Dual purpose – may be used as a wall wrap and/or metal roof sarking
- ✓ Satisfies Bushfire Attack Level (BAL) requirements of 0-40 in roof applications and 0-FZ in wall applications (in accordance with AS 3959 – 2009)
- ✓ Incorporates an anti-glare coating on one side for added install safety
- ✓ Superior strength to weather and tearing

Hints

- When installed adjacent to a minimum 20mm air-space the reflective surface provides increased thermal performance and contributes to the overall energy efficiency of the building
- When overlapped and sealed using Vapastop® 883 aluminium foil tape, provides the dwelling with an effective secondary skin against moisture, vapour, wind, heat and dust penetration into the roof cavity
- Store upright in a cool dry place, away from alkaline corrosive materials such as concrete and lime

Q&A

How do I install as a sarking?

Sisalation® Multipurpose LD & EHD is installed under the battens with a 40mm sag between rafters when used in metal roof applications as a sarking.

What way do I install the wall wrap?

Wall wrap has an anti-glare blue facing which is installed facing outwards from the building to protect the installers eyes from the harsh rays of the sun.

How do you fix wall wrap to wooden frames?

Use foil fasteners and/or a hammer tacker.

How do you fix wall wrap to steel frames?

Use double sided tape or wafer head screws.

Install Example

Metal Roof with Metal Battens

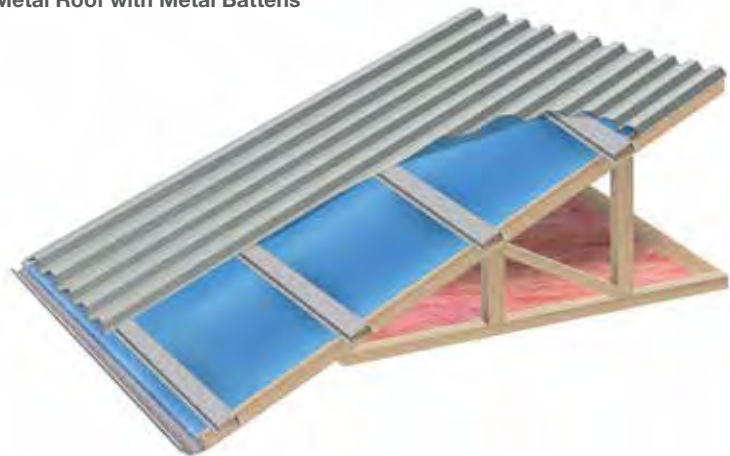

Product	Product code	Width mm	Length m	m ² per roll	Roll weight kg
Sisalation® 439 Multipurpose Light Duty	950260	1350	60	81	19.7
Sisalation® 456 Multipurpose Extra Heavy Duty	952330	1350	30	40.5	9.7
	952360	1350	60	81	19.4
	952331	1500	30	45	10.8

*Next day delivery within branch metro areas.

Sisalation® Foam Cell Resi Liner



Designed for: Use as a reflective foil and vapour barrier for residential stud walls, double brick cavities, under floors, subfloors and tile and metal roof constructions for added insulative properties.

Made from: A closed cell, cross-linked XPE foam core encapsulated between two layers of low emissivity facing foil, one side with an antiglare coating.

- ✓ Next day delivery service available
- ✓ 10 year product warranty
- ✓ Includes a 150mm foil flap to maximise coverage and minimise taping
- ✓ Satisfies Bushfire Attack Level (BAL) requirements of 0-40 in roof applications and 0-FZ in wall applications (in accordance with AS 3959 – 2009)
- ✓ Advanced thermal performance reflecting up to 95% radiant heat, allowing for cooler internal conditions in hot and humid climates
- ✓ Incorporates an anti-glare coating on one side for added install safety
- ✓ Aids in the prevention of condensation
- ✓ Effective water and vapour barrier
- ✓ Maximum durability and increased tear resistance
- ✓ Allows for easy and rapid installation

Hints

- When taping joints, use a plastic squeegee to assist in applying an appropriate amount of pressure along the seam of the tape
- Store upright in a cool dry place, away from alkaline corrosive materials such as concrete and lime
- A minimum 25mm air-space adjacent to each side of the product is recommended
- Allow a minimum clearance of 50mm around hot-flues to avoid being a fire hazard
- Refer to installation guide for full details
- Leaving an airspace can provide an additional R-value by retarding radiant heat flow, refer to FletcherSpec® Pro for further specification details

System Example

Pitched Tiled Roof

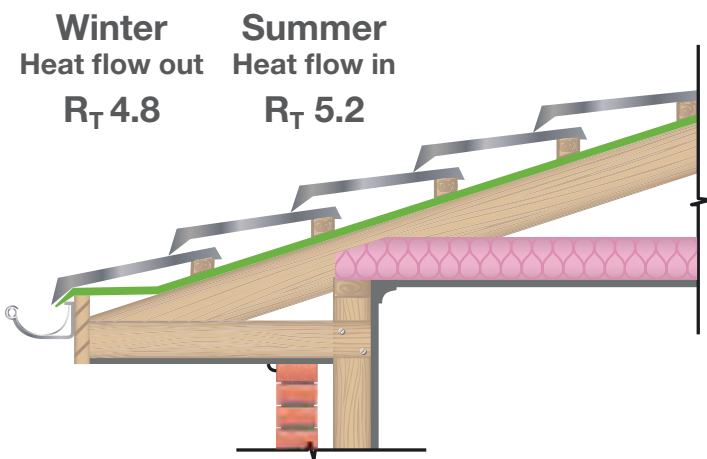

Pitched tiled roof between 18° and 35°, Sisalation® Foam Cell Resi Liner under battens, anti-glare facing upwards. Pink Batts® R3.5 175mm insulation, positioned between joists on 10mm plasterboard lining.

Product code	Width mm	Lap mm	Length m	m ² per roll
395266	1350	150	22.25	30

Pink® and Pink Batts® are registered trademarks of Owens Corning used under licence by Fletcher Insulation Pty Ltd.
*Next day delivery within branch metro areas..

Sisalation® Foam Cell Multipurpose



Designed for: Use as a 3-in-1 multipurpose insulation, vapour barrier and thermal break solution for steel framed residential wall and roof construction, to reduce the thermal bridging and conductivity between building elements. It is commonly also used in timber framed roof construction for added insulative properties.

Made from: A closed cell, cross-linked XPE foam core encapsulated between two layers of low emissivity reflective laminate, one side with an anti-glare coating.

- ✓ Next day delivery service available*
- ✓ 10 year product warranty
- ✓ Suitable for use as a thermal break for steel framed constructions in accordance with NCC requirements
- ✓ Includes a 150mm foil flap to maximise coverage and minimise taping
- ✓ Satisfies Bushfire Attack Level (BAL) requirements of 0-40 in roof applications and 0-FZ in wall applications (in accordance with AS3959 – 2009)
- ✓ Advanced thermal performance reflecting up to 95% radiant heat, allowing for cooler internal conditions in hot and humid climates
- ✓ Incorporates an anti-glare coating on one side for added installation safety
- ✓ Aids in the prevention of condensation
- ✓ Maximum durability and increased tear resistance
- ✓ Allows for easy and rapid installation

Hints

- When taping joins, use a plastic squeegee to assist in applying an appropriate amount of pressure along the seam of the tape
- Store upright in a cool dry place, away from alkaline corrosive materials such as concrete and lime
- Allow a minimum clearance of 50mm around hot-flues to avoid being a fire hazard
- Refer to installation guide for full details

System Example

Pitched Metal Roof

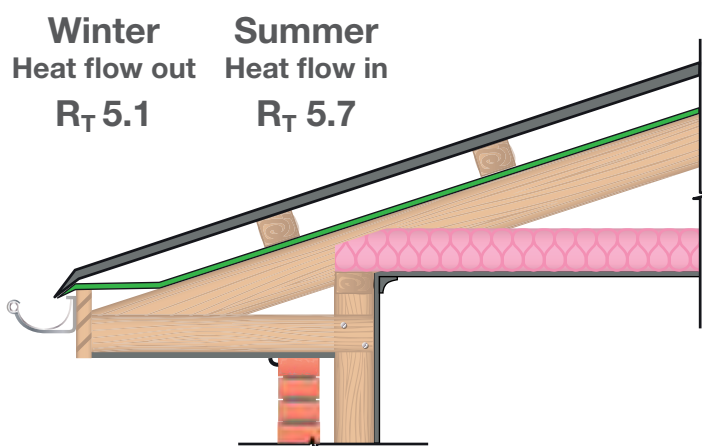

Pitched metal roof between 18° and 35°, Sisalation® Foam Cell Multipurpose under battens, anti-glare facing upwards. Pink Batts® R3.5 175mm insulation, positioned between joists on 10mm plasterboard lining.

Material R-value	Product code	Nominal thickness mm	Width mm	Lap mm	Length m	m ² per roll
R0.20	395264	8.4	1350	150	22.25	30

*Next day delivery within branch metro areas.

Thermatape™ Thermal Break Strip

Fletcher®
Insulation

Building Better, Together.



Designed for: Use to create a thermal break between the steel frame and the outer cladding material. As well as minimising heat leakage through metal window frames in a home when installed behind the window.

Made from: Cross-linked polyethylene and silicone coated paper with adhesive.

- ✓ 10 year product warranty
- ✓ High quality polyethylene structure
- ✓ Self-adhesive with peel off backing
- ✓ Achieves a material R-value of R0.20
- ✓ Suitable for use as a thermal break for steel framed constructions in accordance with NCC requirements
- ✓ Reduces the flow of thermal energy between conductive materials such as lightweight metal cladding and steel frames
- ✓ Excellent compression resistance
- ✓ User friendly, no protective clothing required

Hints

- Ensure surface is clean and free from dust and oil residue, clean with turpentine for best results before applying
- Can be easily cut down to requirement using a sharp retractable blade knife

Q&A

What is the availability?

Availability varies from next day delivery to 10 working days plus transit time. Consult your local branch for availability and lead times.

Install Example



Material R-value	Product code	Nominal thickness mm	Width mm	Length m
0.2	318004	10	30	10

Tapes

Vapastop® 883 Reinforced Foil Tape



Designed for: Use with Sisalation® products to create a vapour sealed join.

Made from: Laminated polyethylene film, polyethylene fibre mesh and aluminium foil.

- ✓ Next day delivery service available*
- ✓ 10 year product warranty
- ✓ Strong reinforced tape
- ✓ Excellent fire retardant properties
- ✓ Pressure sensitive adhesive
- ✓ Conforms well to corners and irregular surfaces
- ✓ Hand tearable, can be torn across its width
- ✓ User friendly, no protective clothing required
- ✓ Operating service temperature range 10°C - 65°C

Hints

- Ensure surface is clean and free from dust and oil residue, clean with turpentine for best results before applying
- When taping joins, use a plastic squeegee to assist in applying an appropriate amount of pressure along the seam of the tape

Product code	Width mm	Length m	Rolls per carton
318039	24	50	48
318040	48	50	24
318080	63	50	16
318085	72	50	16
318086	96	50	12
318502	120	50	8
318501	144	50	8

Plain Foil Tape



Designed for: Use with Sisalation® products to create a vapour sealed join.

Made from: Dead soft aluminium foil with synthetic rubber / resin on one side.

Product code	Width mm	Length m	Rolls per carton
318400	48	50	24
318405	72	50	16
318410	96	50	12

*Next day delivery within branch metro areas.

Residential Product Application Guide

■ Denotes suitable applications and credentials.

Product	Application												Credentials												
	Acoustic			Locational Use					Wall Wrap		Type of Product			Australian Made	Good environmental choice Australia (GECA)	Global Mark ISO 9001	Made from Recycled materials	FBS-1 Glasswool Bio-soluble Insulation	Zero Ozone Depleting	BAL 0-40 Compliant AS 3959-2009	Non Combustible AS 1530.1:1994				
	Basic	Superior	Ultra	Walls	Inta-Floors & Subfloors	Ceilings	Tile Roofs	Metal Roofs	Breather	Permeable	Vapour Barrier	Tapes	Fire Control									Reflective	Thermal Break		
Pink Batts®																									
Pink Batts® HD																									
Pink® Floor Batts																									
Pink® Soundbreak®																									
Polyester Thermal Batts																									
Polyester Underfloor Batts																									
Polyester Acoustic Batts																									
Sisalboard® (EPS)																									
PIRITHERMAFORM® PIR Insulation																									
Fire Stop Party Wall Batts																									
Fire Seal																									
Fire Strips																									
Loaded Vinyl Barrier																									
Pipe Acoustic Lagging																									
Permastop® Building Blanket																									
Pink® EmberGuard® Building Blanket																									
Sisalation® Tuff Wrap™ Standard 497																									
Sisalation® Tuff Wrap™ Breather 498																									
Sisalation® Vapawrap™ Wall																									
Sisalation® Vapawrap™ Metal Roof																									
Tyvek® HomeWrap®																									
Dupont® Flashing Tape																									
Dupont® Contractor Tape																									
Sisalation® Tile Roof HD 465																									
Sisalation® Metal Roof MD 433																									
Sisalation® Multipurpose LD 453																									
Sisalation® Multipurpose EHD 456																									
Sisalation® Foam Cell Resi Liner																									
Sisalation® Foam Cell Multipurpose																									
Thermatape™ Thermal Break Strip																									
Vapastop® 883 Reinforced Foil Tape																									
Plain Foil Tape																									

© Fletcher Insulation 2016. Fletcher Insulation reserves the right to change product specifications without prior notification. Information in this publication and otherwise supplied to users as to the subject product is based on our general experience and is given in good faith, but because of the many particular factors which are outside our knowledge and control and affect the use of products, no warranty is given or is to be implied with respect to either such information or the product itself, in particular the suitability of the product for any particular purpose. The purchaser should independently determine the suitability of the product for the intended application. The colour PINK, is a registered trademark of Owens Corning used under licence by Fletcher Insulation. Unless specified, all other ™ and © are trademarks or registered trademarks of Fletcher Insulation Pty Limited ABN 72 001 175 355.

Fletcher[®] Insulation

Building Better, Together.

Customer Service Phone

1300 654 444

Email info@insulation.com.au

www.insulation.com.au

